

Courses & Distances down  
Pattersons Run Begin<sup>d</sup> at a Ch. X.

- S. 77. E. --- 20
- N. 79. E. --- 60
- N. 68. E. --- 28
- East --- 37
- N. 41. E. --- 30 1/2
- N. 61. E. --- 42
- N. 89. E. --- 33 1/4
- N. 64. E. --- 20
- N. 57. E. --- 18 to the Begin<sup>d</sup> Post.

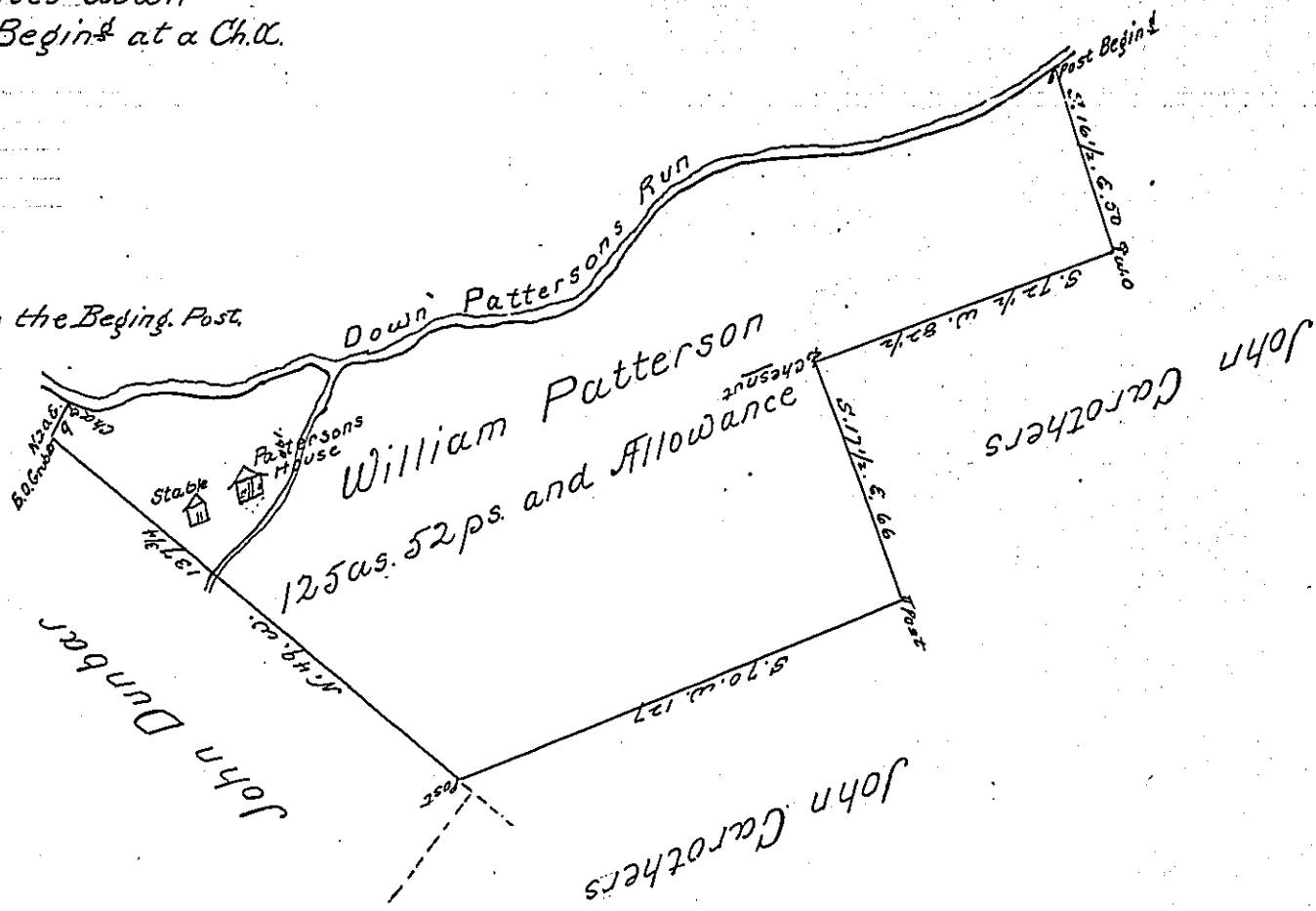

The Draught of a Tract of Land Situate in Tyrone Township Cumberland County, containing One hundred and Twenty five acres & fifty two perches and allowance of Six p<sup>ts</sup> for Roads &c.

Surveyed April 16<sup>th</sup> 1792 in pursuance of a warrant granted to William Patterson dated June 10<sup>th</sup> 1791, and in pursuance of an order of the Honourable Board of Property dated October 3<sup>rd</sup> 1791 for Saml Lyon Esq.

To Daniel Brodhead Esquire  
Surveyor General of Pennsylvania

N.B. The above Recited order of the Board did not come to hand untill after the time ordered for making Report, was expired, &c.

In pursuance of the above recited order of the Honourable Board of Property, we the Subscribers made the above Survey, together with John Dunbar's Survey, in the most commodious manner we were capable of, so as to include Pattersons Cabin, agreeably to the said order, to which it appears to us, the parties have agreed.

Robert Scott  
George Douglass.

IN TESTIMONY that the above is a copy of the original remaining on file in the Department of Internal Affairs of Pennsylvania, made conformably to an Act of Assembly approved the 16<sup>th</sup> day of February, 1833, I have hereunto set my Hand and caused the Seal of said Department to be affixed at Harrisburg, this sixth day of August 1901

*James W. Fisher*  
Secretary of Internal Affairs.